

South Carolina Geographic Alliance

*Center of Excellence
for Geographic Education*

*Department of Geography
University of South Carolina*



GEOFEST 43

February 18, 2012

Columbia, South Carolina

PROGRAM AT-A-GLANCE

Four sessions are available throughout the day. Session locations are noted after the presenter's name. A building map is provided on the facing page. **Opening and Closing sessions are held in Room 011.**

	Session I 9:50-10:35	Session II 10:45-11:30	Session III 12:50-1:35	Session IV 1:45-2:30
Lecture	Religion in SC Mitchell – 201	Mapping Streams James – 201	Lebanon Nagel – 201	Sense of Place Battersby – 201
All Grades		Grants/Institute Caughman – 228	HC PEG Corsini – 101	Population Stjern – 003
Elementary	Around the World Kuhn – 101	Tasting Regions Bridge/Pullie – 101		Europe Claims Rister – 101
Middle	Fun with Geography Bartholomew/Spinks – 102		Google Earth Remington – 302	Google Earth Remington – 302
Middle/High	One Ocean Ashley – 202	Tappan Zee Cantrill/Kearse – 005	Tappan Zee Cantrill/Kearse – 005	GPS Musselman – 005
High	GIS Musselman – 005	Time by Train Schoolfield – 003	APHG Clem – 228	Rotten Tomatoes Cowan – 202

ATTENDANCE DOCUMENTATION

_____ attended the GEOFEST sessions initiated by the presenter on
 (name) February 18, 2012.

SPONSORS

Special thanks to the following organizations for their contributions:

- National Geographic Society • University of South Carolina Department of Geography***
American Geographical Society • Reading Source • Dodge Learning
Joan Loves Books • Elysabeth Eldering Books • Education Oversight Committee • Nystrom
South Carolina Council for the Social Studies • South Carolina State Department of Education
South Carolina Center for Teaching about Asia • Sundance/Newbridge Educational Publishing
Watson Library Services • National Council for Geographic Education

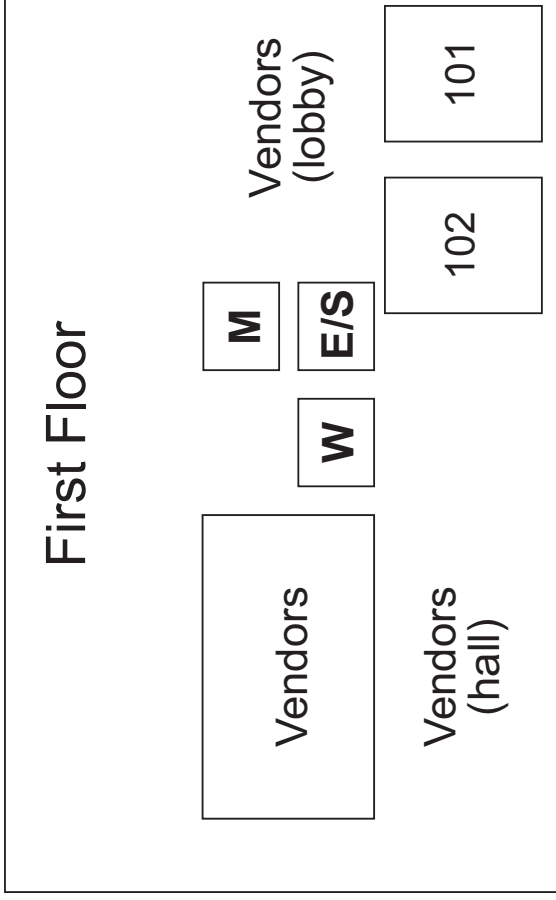
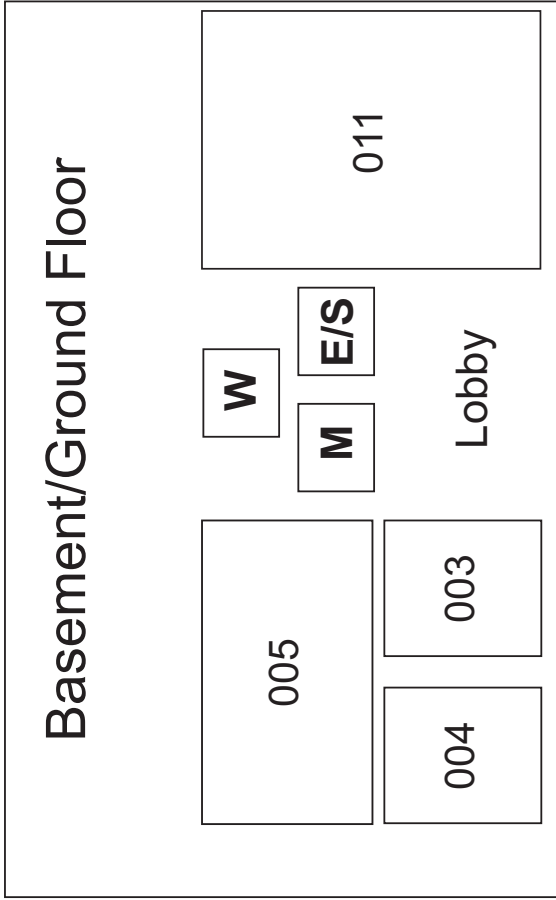

E/S = Elevator/Stairs W = Women's Restroom M = Men's Restroom

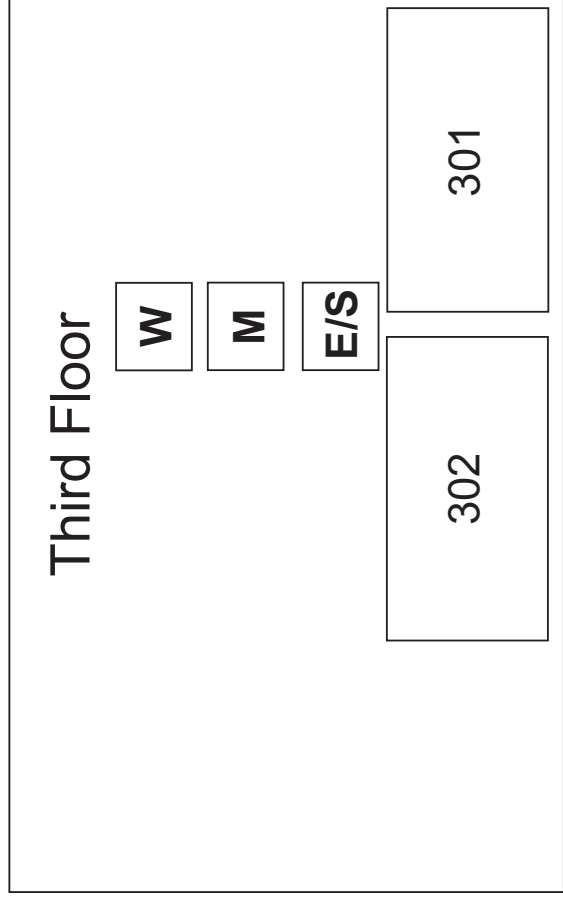
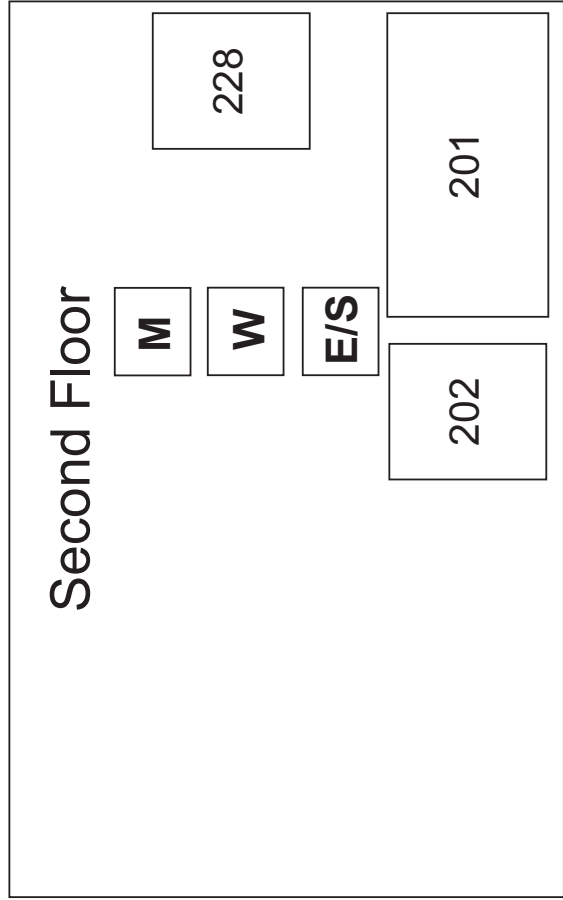

GEOFEST 43 PROGRAM

February 18, 2012

Opening Session

9:30-9:40

Auditorium 011

Session I

9:50-10:35

Religion in South Carolina

Room 201

Audience: All

Dr. Jerry Mitchell, University of South Carolina

In this session we will review geographic interest in religion and the data issues that make religious patterns difficult to represent. South Carolina's current religious landscape, including the spatial distribution of Catholics, Baptists, Muslims, and other groups as represented by the classroom poster *Religious Diversity in South Carolina*, is discussed.

Around the World in 180 Days

Room 101

Audience: Elementary

Barb Kuhn, Prince of Peace Catholic School

My classroom has a big rug with the world map on it. We use this anytime we "go" somewhere in the world. Today we are visiting Australia. We will compare the different types of terrain in North America and Australia, learn about Australian wildlife, and discuss how Australia's climate compares to ours. Copies of the lesson plan will be distributed to all participants.

Fun with Geography

Room 102

Audience: Middle

Amy Bartholomew, Springfield Middle, and Priya Spinks, Springfield Middle

Join us for an overview of sample activities that can be used in the classroom to teach geography through different strategies. Some activities encourage students to get up and move around the room (ex: Geography Aerobics). Be prepared to participate and have fun with geography!

ONE Ocean: ALL Mankind – National Geographic's Marine Ecology Website

Room 202

Audience: Middle/High

Michelle J. Ashley, South Aiken High School

We only have one ocean, and all of mankind wants to use it ... some of us unconditionally. National Geographic has created a fully interactive website of marine lesson plans to complement the ecology section of biology or use in an environmental, marine or earth science unit. Topics range from sustainable fishing, eating seafood responsibly, marine food chains, and trashing our ocean, to preserving what's left of our pristine marine waters. Come for a website preview, participate in one of the lessons, and take home some free marine giveaways.

Geographic Technology: Geographic Information Systems

Room 005

Audience: High

Mark Musselman, Audubon at Francis Beidler Forest

Geographic Information Systems (GIS) allow a user to take vast quantities of data and present the data spatially so that relationships between the data can be easily seen. This session introduces participants to an online GIS software package. Using GIS technology, participants will create a map, interpret data, and predict future outcomes related to different animal and bird species inhabiting the old-growth swamp at the Francis Beidler Forest. Participants will take home detailed instructions on how to employ GIS technology in their classrooms. *This session is limited to 25 participants.*

Session II

10:45-11:30

The Lidar Side of Headwater Stream Mapping: New Technologies for Mapping Rivers in South Carolina

Room 201

Audience: All

Dr. Allan James, University of South Carolina

Surprisingly, little is known about the total length of rivers in the United States because headwater streams have never been properly mapped. Current initiatives in South Carolina are addressing methods for mapping small streams. This presentation will review (1) the importance of knowing where headwater streams are, (2) the use of Light Detection and Ranging (LiDAR) to identify and map headwater streams in SC, and (3) incorporation of the new map data into the National Hydrography Database (NHD). Knowing where channels begin is critical to the development of accurate models for predicting surface water runoff, the generation of erosion, and non-point-source pollution.

SCGA Grants and Geography Summer Institute

Room 228

Audience: All Grades

Monti Caughman, South Carolina Geographic Alliance

Participants will learn about SCGA Teacher Grants (past award examples, how to apply), and the 2012 Geography Summer Institute (course content, objectives, trips, and how to apply).

Tasting Through the Regions

Room 101

Audience: Elementary

Rebecca Bridge, Whitesville Elementary, and Sarah Pullie, Latta Elementary

Using many candies and treats, we will label a map of the landform regions of South Carolina. The goodies chosen will represent a crop, landform or industry found in each region. Although the main focus will be the landform regions of South Carolina, we also will discuss how this tasty idea can be adapted for other places and grade levels.

The Why and Where of the Tappan Zee Bridge

Room 005

Audience: Middle/High

Jeremy Cantrill, University of South Carolina, and Justin Kears, University of South Carolina

Social studies literacy skills include the ability of students to interpret Earth's physical and human systems by using maps, mental maps, geographic models, and other social studies resources. These resources include aerial photographs, satellite-produced images, and geographic information systems. In this session, participants will use Google Earth and an online geographic information system to explore the siting process for New York's curiously placed Tappan Zee Bridge. Although geographers believe there are reasons for things being where they are, session participants will realize that those reasons may not always seem reasonable. A copy of the lesson will be distributed. *This session is limited to 25 participants.*

Telling Time by the Train

Room 003

Audience: High

Dr. Brenda Schoolfield, Bob Jones University

This session will inform teachers of the connections between keeping time and geography. Teachers will learn a few classroom activities that will help students make the connections and think geographically using the Five Themes of Geography. Come prepared to explore clocks, maps, trains, and time.

LUNCH

11:30-12:45

Grand Marketplace

Session III

12:50-1:35

Lebanon and the Arab World in Transition

Room 201

Audience: All

Dr. Caroline Nagel, University of South Carolina

While small in area and population, Lebanon has long attracted the attention of world powers because of its geographical position between the Arab East and the European West. Much as in the past, world powers are attempting to control political outcomes in Lebanon by cultivating ties with different confessional groups. As the Arab world experiences momentous political changes, will Lebanon become the global model for inter-faith coexistence, or will it fall prey to destabilizing forces inside and outside the country?

Invite HC PEG into your Classroom

Room 101

Audience: All Grades

Stephen Corsini, Irmo Elementary

This lesson uses the acronym, HC PEG*, to help students incorporate the themes of Social Studies into each unit of study and their daily lives. An introductory unit and follow up activities will be presented that participants can tweak to suit their own needs. **History, Culture, Political (Science), Economics, Geography*

The Why and Where of the Tappan Zee Bridge

Room 005

Audience: Middle/High

Jeremy Cantrill, University of South Carolina, and Justin Kears, University of South Carolina

Social studies literacy skills include the ability of students to interpret Earth's physical and human systems by using maps, mental maps, geographic models, and other social studies resources. These resources include aerial photographs, satellite-produced images, and geographic information systems. In this session, participants will use Google Earth and an online geographic information system to explore the siting process for New York's curiously placed Tappan Zee Bridge. Although geographers believe there are reasons for things being where they are, session participants will realize that those reasons may not always seem reasonable. A copy of the lesson will be distributed. *This session is limited to 25 participants.*

Google Earth for the Classroom

Room 302

Audience: Middle

Kevin Remington, University of South Carolina

With reduced budgets for field trips, learn how Google Earth technology of today can take your students to places without leaving the classroom. This session will teach educators to incorporate technology into the history and social studies curricula by incorporating text and pictures into Google Earth, with a particular focus on South Carolina. *This session is limited to 20 participants.*

AP[®] Human Geography Forum and FRQ Grading

Room 228

Audience: High

Jerry Clem, Lower Richland High School

Join us for an opportunity to share ideas and issues about teaching AP[®] Human Geography. Participants will discuss grading FRQs (free response questions) for the AP[®] Human Geography exam. Sample student question responses and a grading rubric are among the session topics.

*AP, Advanced Placement and Advanced Placement Program are registered trademarks of the College Board, which was not involved in the production of and does not endorse this forum.

Session IV

1:45-2:30

What and Where is "The South?" Evaluating Our Sense of Place

Room 201

Audience: All

Dr. Sarah Battersby, University of South Carolina

Place, boundaries, and our perceptions of / senses of space differ from person to person, so how can we evaluate them to help make sense of our shared environment? This session introduces techniques for examining how places are perceived by different individuals. Techniques discussed will include creating and evaluating sketch maps, examining fuzzy boundaries (e.g., the "grits line" or the "sweet tea line"), and fun ways of collecting and analyzing qualitative data with students.

Population Connection!

Room 003

Audience: All Grades

Chuck Stjern, Pinewood Preparatory

Come and watch a demonstration of some fun lessons on population and resource sustainability: "The Stork and the Grim Reaper," "Earth, the Apple of Our Eye," "Eco-ethics," "Food for Thought," and the shortest, best video on population, "World Population." *This session is limited to 30 participants.*

Europeans and a Line of Proclamation

Room 101

Audience: Elementary

Paige Rister, Little Mountain Elementary

Use Google Earth, literature, note-booking, and other media to showcase the nations and land claims in North America after 1763. Students will use geographic knowledge and map skills to depict how the nations of England, Spain, and France claimed certain territories of the New World. Students will use play-dough to color code the land claims and mark each section with the specific country's flag.

Google Earth for the Classroom

Room 302

Audience: Middle

Kevin Remington, University of South Carolina

With reduced budgets for field trips, learn how Google Earth technology of today can take your students to places without leaving the classroom. This session will teach educators to incorporate technology into the history and social studies curricula by incorporating text and pictures into Google Earth, with a particular focus on South Carolina. *This session is limited to 20 participants.*

Geographic Technology: Global Positioning Systems

Room 005

Audience: Middle/High

Mark Musselman, Audubon at Francis Beidler Forest

Global Positioning Systems (GPS) allow for short outdoor course navigation and student-collected data of all types. This session will venture outdoors on the USC campus to learn how to use a hand-held GPS receiver. Participants will take home detailed instructions on how to employ GPS technology in their classrooms. *This session is limited to 20 participants.*

Rotten Tomatoes in Sweet Home Alabama

Room 202

Audience: High

Stan Cowan, Westside High

In 2009, Alabama passed one of the most stringent anti-immigration laws in U.S. History. The result has been statewide social turmoil and potential economic calamity. Is this a trend or a backlash, and what are our students to make of it all?

Closing Session

2:40-3:00

Auditorium 011